

RL70000 SS Double-Ended Beam, Stainless Steel, IP67

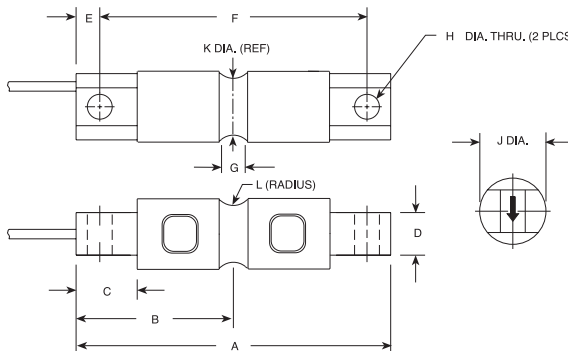

Picture is a representation of actual product



RATED CAPACITY	DIMENSIONS											
	A	B	C	D	E	F	G	H	J	K	L	
lb/inches												
5000-10,000	8.12	4.06	1.44	1.12	.62	6.88	.62	.66	1.83	1.48	.50	
20,000	8.12	4.06	1.44	1.12	.84	6.88	.84	.66	2.08	1.48	.50	
30,000-60,000	10.25	5.12	1.88	2.37	.88	8.50	1.00	1.06	3.20	2.73	1.00	
100,000	11.25	5.62	1.88	2.50	.88	9.50	1.00	1.06	3.75	3.24	1.50	
150,000	11.25	5.62	1.88	2.80	.88	9.50	1.25	1.06	3.90	3.64	1.50	
kg/mm												
2268.0-4535.9	206.3	103.1	36.6	28.5	15.8	174.8	15.8	16.8	55.9	37.6	12.7	
9071.9	206.3	103.1	36.6	14.2	21.3	174.8	21.3	16.8	52.8	37.6	12.7	
13,607.8-27,215.6	260.4	130.1	47.8	60.2	22.4	215.9	25.4	26.9	81.3	69.3	25.4	
45,359.4	285.8	142.8	47.8	63.5	22.4	241.3	25.4	26.9	95.3	82.3	25.4	
68,093.1	285.8	142.8	47.8	63.5	22.4	241.3	31.8	26.9	95.3	92.5	38.1	

SPECIFICATIONS:

Full Scale Output:	3.0 mV/V	Deflection at Capacity:	5000 lb = .025"/.6 mm, 10,000 lb = .025"/.6 mm, 20,000 lb = .042"/1.1 mm, 30,000-50,000 lb = .02"/.5 mm, 60,000 lb = .025"/.6 mm, 100,000-150,000 lb = .02"/.5 mm
Bridge Resistance:	700 ohms, nominal	Seal Type:	Environmentally-sealed, IP67
Material/Finish:	Stainless steel	Cable Length:	30'/9.2 m
Temperature:	Compensated range 0°F to 150°F/-18°C to 65°C	Cable Color Code:	Red..... + Excitation Black..... - Excitation Green..... + Signal White..... - Signal Orange.... Shield
Safe Overload:	150% Full scale	Warranty:	2-year limited warranty
Rated Excitation:	10V AC/DC (15V max)		
Non-repeatability:	0.02% Full scale		
Combined Error:	0.1% Full scale		
Insulation Resistance:	5000 megohms		

RL70000 SS ORDER INFORMATION

Rated Capacity	Part #	Price
5000 lb (2268.0kg)	30431	\$700.00
10,000 lb (4535.9 kg)	30432	\$750.00
20,000 lb (9071.9 kg)	30433	\$750.00
30,000 lb (13,607.8 kg)	30434	\$825.00
40,000 lb (18,143.7 kg)	30435	\$825.00
50,000 lb (22,679.6 kg)	30436	\$925.00
60,000 lb (27,215.5 kg)	30437	\$925.00
100,000 lb (45,359.2 kg)	30444	\$1,825.00
150,000 lb (68,038.9 kg)	30445	\$1,895.00
Conduit Adapter Kit* (must be factory installed to maintain warranty)		
3/8-24 Nipple	31533*	\$25.00
3/8-24 to 1/4-18 NPT	31534*	\$25.00
5/8-18 UNF/1/2-14 NPT	31535**	\$35.00

INTERCHANGEABLE PRODUCTS

Manufacturer	Model
Rice Lake Weighing Systems(see page 137) RL71000 HE
Vishay Revere Transducers(see page 276) 9103
Artech SS70210

WEIGH MODULE AVAILABLE

Model	Page #
EZ Mount 160

* On capacities of 5000 to 20,000 lb, parts #31533 and #31534 must be installed together to form the Conduit Adapter Kit

** On capacities of 30,000 to 150,000 lb, order part #31535