

RL20001 HE S-Beam, Stainless Steel

Welded-seal, IP67, NTEP 1:5000 Class III/1:10000 Class III L Single Cell

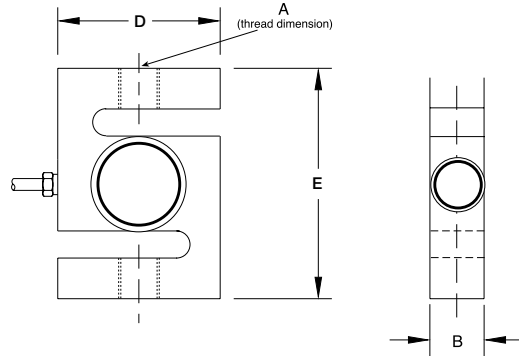

Picture is a representation of actual product



RATED CAPACITY	DIMENSIONS			
	A	B	D	E
lb/inches				
750-3000	1/2-20 UNF	1.00	2.00	3.00
5000-10,000	3/4-16 UNF	1.00	3.50	4.75
kg/mm				
226.8-1360.8	1/2-20	25.4	50.8	76.2
2268.0-4535.9	3/4-16	25.4	88.9	120.7
6803.9	1-14	31.8	101.6	139.7
9071.9	1 1/4-12	76.2	127.0	177.8

SPECIFICATIONS:

Full Scale Output:	2.0 mV/V	Hysteresis:	0.02% Full scale
Bridge Resistance:	350 ohms, nominal	Insulation Resistance:	5000 megohms
Material/Finish:	Stainless steel	Seal Type:	Welded-seal, IP67
Temperature:	Compensated range 14°F to 104°F/-10°C to 40°C	Cable Length:	20'/6.1 m
Safe Overload:	150% Full scale	Cable Color Code:	Red + Excitation Black..... - Excitation Green..... + Signal White - Signal
Rated Excitation:	10V DC (15V maximum)	Warranty:	Two-year limited warranty
Nonlinearity:	0.03% Full scale		

RL20001 HE ORDER INFORMATION

Load Rating	Part #	Price
RL20001HE NTEP		
750 lb (340.2 kg)	46470	\$825.00
1000 lb (453.6 kg)	46471	\$825.00
1500 lb (680.4 kg)	46472	\$825.00
2000 lb (907.2 kg)	46473	\$825.00
2500 lb (1134.0 kg)	46474	\$825.00
3000 lb (1360.8 kg)	46475	\$825.00
5000 lb (2268.0 kg)	46476	\$1,095.00
RL20001HE Non-NTEP		
10,000 lb (4535.9 kg)	36292	\$1,095.00

INTERCHANGEABLE PRODUCTS

Manufacturer	Model
Vishay Sontortronics(see page 298) 60063

WEIGH MODULE AVAILABLE

Model	Page #
ITCM Isolated Tension Cell Mount357