

# RL20000 S-Beam, Alloy Steel

## NTEP 1:10,000 III L Single Cell, IP67

### 1:5000 III/1:10,000 IIIL



Picture is a representation of actual product

#### SPECIFICATIONS:

<b>Full Scale Output:</b>	<b>3.0 mV/V</b>
<b>Bridge Resistance:</b>	<b>350 ohms, nominal</b>
<b>Material/Finish:</b>	<b>High-alloy steel, nickel plated</b>
<b>Temperature:</b>	Compensated range 14°F to 104°F/-10°C to 40°C
<b>Seal Type:</b>	Environmentally-sealed, IP67
<b>Safe Overload:</b>	150% Full scale
<b>Rated Excitation:</b>	10V DC (15V maximum)
<b>Nonlinearity:</b>	0.03% Full scale
<b>Hysteresis:</b>	0.02% Full scale
<b>Insulation Resistance:</b>	5000 megohms
<b>Cable Length:</b>	20'/6.1 m
<b>Cable Color Code:</b>	Red ..... + Excitation Black..... - Excitation Green..... + Signal White ..... - Signal
<b>Warranty:</b>	2-year limited warranty

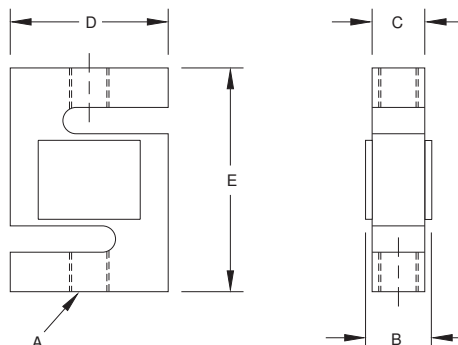

#### RATED CAPACITY

	A	B	C	D	E
<b>lb/inches</b>					
25-300	1/4-28 UNF-2B	.75	.50	2.00	2.50
500-1500	1/2-20 UNF-2B	1.00	.75	2.00	2.50
2000-2500	1/2-20 UNF-2B	1.25	1.00	2.00	2.50
3000	1/2-20 UNF-2B	1.25	1.00	3.00	4.00
5000-10,000	3/4-16 UNF-2B	1.25	1.00	3.00	4.00
15,000	1-12 UNF-2B	1.50	1.25	4.00	5.50
20,000	1 1/4-12 UNF-2B	2.25	2.00	5.00	7.00

#### kg/mm

11.3-136.1	1/4-28 UNF-2B	19.1	12.7	50.8	63.5
226.8-680.4	1/2-20 UNF-2B	25.4	19.1	50.8	63.5
907.2-1134.0	1/2-20 UNF-2B	31.8	25.4	50.8	63.5
1360.8	1/2-20 UNF-2B	31.8	25.4	76.2	101.6
2268.0-4535.9	3/4-16 UNF-2B	31.8	25.4	76.2	101.6
6803.9	1-12 UNF-2B	38.1	31.8	101.6	139.7
9071.9	1 1/4-12 UNF-2B	57.2	50.8	127.0	177.8

#### RL20000 ORDER INFORMATION

Load Rating	Part #	Price
25 lb (11.3 kg)	21428	\$275.00
50 lb (22.7 kg)	21429	\$275.00
75 lb (34.0 kg)	21430	\$275.00
100 lb (45.4 kg)	21431	\$275.00
150 lb (68.0 kg)	21432	\$275.00
200 lb (90.7 kg)	21433	\$275.00
250 lb (113.4 kg)	21434	\$275.00
300 lb (136.1 kg)	21435	\$275.00
500 lb (226.8 kg)	21436	\$275.00
750 lb (340.2 kg)	21437	\$275.00
1000 lb (453.6 kg)	21438	\$275.00
1500 lb (680.4 kg)	21439	\$275.00
2000 lb (907.2 kg)	21440	\$275.00
2500 lb (1134.0 kg)	21441	\$275.00
3000 lb (1360.8 kg)	21442	\$315.00
5000 lb (2268.0 kg)	21443	\$440.00
10,000 lb (4535.9 kg)	21444	\$440.00
15,000 lb (6803.9 kg)	21445	\$555.00
20,000 lb (9071.9 kg)	21446	\$875.00

**Conduit Adapter Kit\* (must be factory installed to maintain warranty)**  
 3/8-24 Nipple .....31533\* .....\$25.00  
 3/8-24 to 1/4-18 NPT .....31534\* .....\$25.00

\* Parts #31533 and #31534 must be installed together to form the Conduit Adapter Kit

#### INTERCHANGEABLE PRODUCTS

Manufacturer	Model
**Artech.....	20210
<i>(15K has 1"-14)</i>	

#### WEIGH MODULE AVAILABLE

Model	Page #
ITCM Isolated Tension Cell Mount .....	371

\*\* Except 15K